



THE GENERAL

BRISTOL

Floorplan – Plot 04-08

2 bedroom apartment

Upper Ground Floor

Total area 783sq ft (72.7sq m)

Living/Dining	22ft 12in x 19ft 0in	(7.0m x 5.8m)
Kitchen		
Bedroom 1	11ft 10in x 10ft 10in	(3.6m x 3.3m)
Bedroom 2	8ft 10in x 12ft 6in	(2.7m x 3.8m)

▲
N

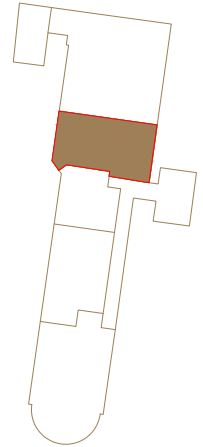

01179 255 333
sales@cityandcountry.co.uk
www.cityandcountry.co.uk

CITY & COUNTRY