

GROUND FLOOR LOCATOR

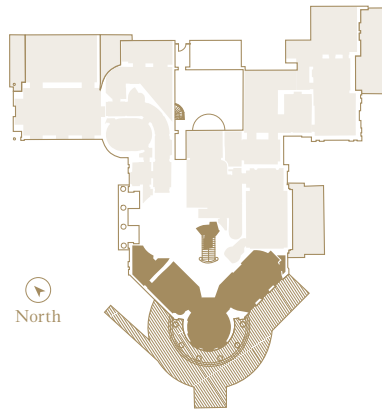

DIMENSIONS

Total NSA 1,658 sq ft / 154 sq m

Ground Floor	Kitchen / Dining Room	6.5m x 5.5m	21'3" x 18'1"
	Drawing Room	8.1m x 6.3m	26'6" x 20'10"
	Master Bedroom	6.3m x 5.5m	20'10" x 18'2"
	Bedroom 2	4m x 3.8m	13'3" x 12'8"



The Mansion at Sundridge Park, Bromley, London BR1 3FZ

020 3369 2222 - www.cityandcountry.co.uk

the
NASH
floorplan



PLOT NO.1 THE MANSION

CITY & COUNTRY

The information in this document is intended as a guide only and is subject to change without prior notice. Accordingly, due to the City & Country policy of continual improvement, the finished product may vary from the information provided and City & Country reserves the right to amend the specification. All dimensions stated are approximate only with maximum dimensions and may alter through the construction phase and with interior finishes. You are therefore advised not to order any goods which depend upon accurate dimensions before carrying out a check measure within your reserved property.

THE NASH

TWO BEDROOM, GROUND FLOOR, SINGLE STOREY APARTMENT

The entrance to this characterful single storey, two bedroom apartment is located opposite The Mansion's grand main staircase. The impressive circular living space, situated within the iconic rotunder, boasts intricate original ceiling decoration and fireplace, with views over the golf course. The breathtaking master bedroom features restored wall and ceiling cornicing and an imposing timber 'Adam's style' fireplace. Flooded with natural light the bedroom has a luxurious en suite pod with freestanding bath. This property comes complete with 13 original ceiling paintings which have been meticulously restored and benefits from a private double garage.

