



The Mansion at Sundridge Park, Bromley, London BR1 3FZ  
020 3369 2222 ~ [www.cityandcountry.co.uk](http://www.cityandcountry.co.uk)

*the*  
HANOVER  
*floorplan*



PLOT NO.8 THE MANSION

The information in this document is intended as a guide only and is subject to change without prior notice. Accordingly, due to the City & Country policy of continual improvement, the finished product may vary from the information provided and City & Country reserves the right to amend the specification. All dimensions stated are approximate only with maximum dimensions and may alter through the construction phase and with interior finishes. You are therefore advised not to order any goods which depend upon accurate dimensions before carrying out a check measure within your reserved property.

CITY & COUNTRY

## THE HANOVER

### TWO BEDROOM, FIRST FLOOR, SINGLE STOREY APARTMENT

A beautiful light-filled apartment, occupying a prominent position at the front of The Mansion with views through the impressive Nash colonnades. The apartment features a separate drawing room and kitchen/dining room. The master bedroom with dressing area is very spacious and has a luxurious en suite, with views to The Mansion's internal courtyard. The second double bedroom also benefits from an en suite and enjoys views over the landscaped entrance courtyard.

#### FIRST FLOOR LOCATOR

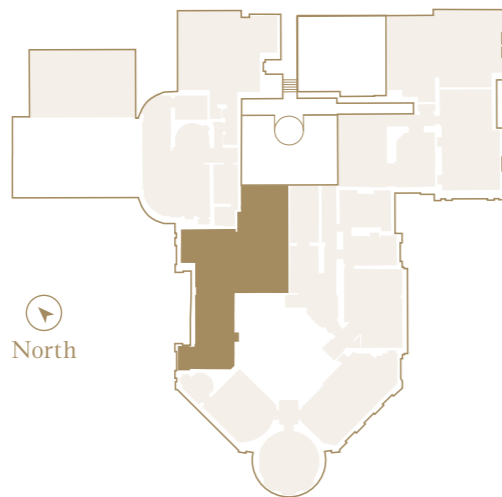

#### DIMENSIONS

Total NSA 1,341 sq ft / 124 sq m

First Floor	Kitchen / Dining Room	5.8m x 4.6m	19'2" x 15'3"
	Drawing Room	5.9m x 4.2m	19'4" x 13'9"
	Master Bedroom	6.2m x 4.8m	20'3" x 15'11"
	Bedroom 2	4.4m x 3.6m	14'6" x 12'

