



THE GENERAL BRISTOL

Floorplan – Plot 04-06

2 bedroom apartment

Lower Ground Floor

Total area 836sq ft (77.7sq m)

| | | |
|---------------|---------------------|---------------|
| Living/Dining | 17ft 1in x 16ft 1in | (5.2m x 4.9m) |
| Kitchen | 9ft 2in x 9ft 11in | (2.8m x 3.0m) |
| Bedroom 1 | 14ft 9in x 9ft 6in | (4.5m x 2.9m) |
| Bedroom 2 | 13ft 9in x 8ft 2in | (4.2m x 2.5m) |

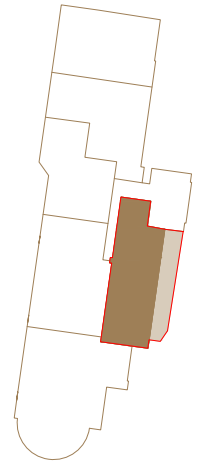

01179 255 333
sales@cityandcountry.co.uk
www.cityandcountry.co.uk

CITY & COUNTRY